

Bownut (Metric Thread) - Drop Forged

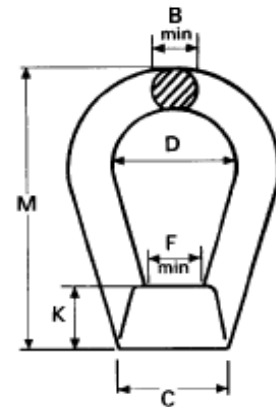

- * Drop Forged standard bownut
- * **Material:** As specified by BS 3974
- * Not to be used for Inclined Lifting
- * **Certificates:** Relevant certificates supplied



Code	WLL KGS	Thread Size	B min mm	C mm	F min mm	K mm	M mm	D mm	Weight Each Kgs
BN10	360	M10	7	32	14	16	64	25	0.2
BN12	530	M12	9	38	16	18	73	30	0.3
BN16	1010	M16	12	38	20	18	73	30	0.3
BN20	1580	M20	14	45	24	25	102	40	0.6
BN24	2280	M24	17	50	28	28	124	50	0.9

***NOT TO BE USED FOR INCLINED LIFTING**